

The information contained in this drawing is the sole property of CWS Coil Winding Specialist. Any reproduction in part or whole without written permission of CWS Coil Winding Specialist is prohibited.

REVISION HISTORY

REV	ECN	DESCRIPTION	SIGN & DATE
A		PRODUCTION RELEASE	TKK 2/9/04 JLU 2/9/04

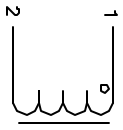

SCHEMATIC

USING A PERMANENT MARKING METHOD  
 MARK PART NUMBER AND REVISION, IF APPLICABLE  
 IF NEEDED, WRAP INDUCTOR WITH GLASS TAPE

TO THE CORE  
 MUST REST FLAT ON PCB. LEADS MUST BE TANGENT  
 FLUSH WITH THE COIL EDGE. AS SHOWN (I.E. COIL  
 REMOVE INSULATION AND TIN LEADS 0.5 INCH

WIND COILS EVENLY SPACED AROUND THE CORE  
 CONSTRUCTION:

HIPOT TEST FOR WINDING TO CORE ISOLATION = 500VDC MIN  
 CURRENT RATING : 3.3 AMPS, 40 °C TEMP. RISE, NO AIR FLOW  
 DCR 65.0 MILLIOHMS MAX.  
 DC BIASED = 3.3 AMPS, INDUCTANCE = 81 UH  
 DC BIASED = 4.7 AMPS, INDUCTANCE = 80 UH  
 INDUCTANCE = 100 UH +10% @ LOW DC BIAS, 1 KHz, 250mV  
 SPECIFICATIONS:

WIRE: UL RECOGNIZED 200°C RATED MAGNET WIRE  
 CWS BYTE-MARK OR OTHER APPROVED PART  
 CORE: COATED HIGH FLUX TOROIDAL CORE

RATING CLASS B (130°C MIN.) REQUIRED  
 MATERIAL: UL RECOGNIZED 94V-0 FOR FLAMMABILITY

NOTES: TOROIDAL POWER CHOKE. ALL DIMENSIONS IN INCHES

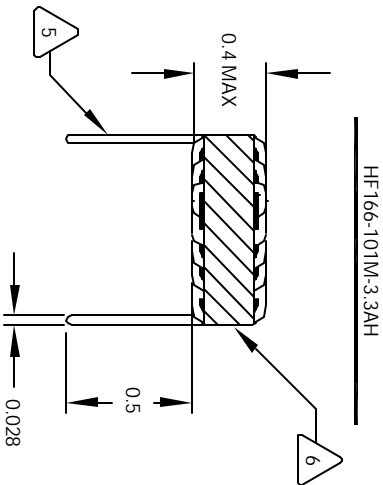

FRONT VIEW

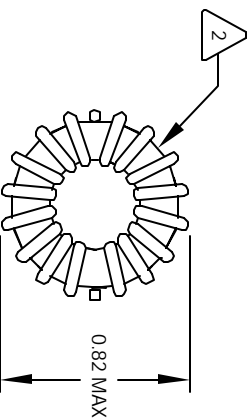

BOTTOM VIEW

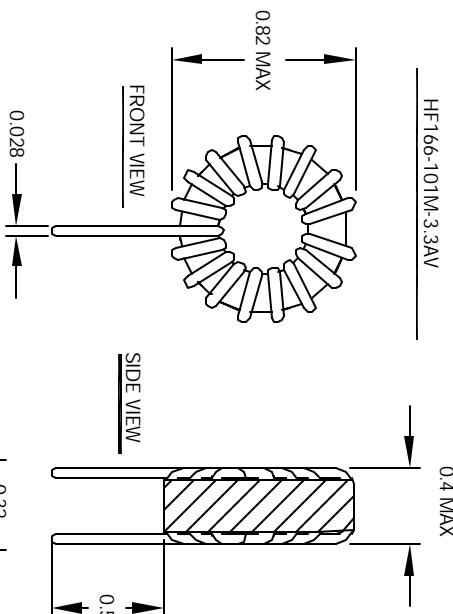

FRONT VIEW

SIDE VIEW

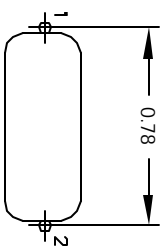

MOUNTING HOLES PATTERN

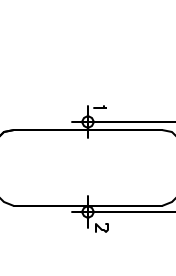

MOUNTING HOLES PATTERN

CODE IDENT	MFG. P/N	DESCRIPTION	ITEM NO.
AUTOCAD SOLIDWORKS SIGN	X		
PARTS LIST			
DATE	DATE	CWS Coil Winding Specialist 1510 E. Edinger Ave. Unit B, Santa Ana, CA 92705	
TKK 2/8/04	TKK 2/9/04		
JLU 2/9/04	JLU 2/9/04		
JLU 3/8/04	JLU 3/8/04		
TITLE:		Toroidal Power Chokes	
SIZE:		B	
SCALE:		2=1	
REV:		B	
SHEET:		1 OF 1	